



PowerPort™

Feel the new Standard of Care



The PowerPort™ Implantable Ports

Now available in
Titanium and
Radio-Translucent
Material

Enables Reliable Venous Access :

- Receive IV therapies
- Reduce repeated needle sticks
- Receive Contrast-Enhanced CT (CECT) scans
- Easy, Flexible placement and access

Features & Benefits to

PowerPort™ *isp* M.R.I.™ device:

- Light Weight for Patient Comfort
- Radio Translucent - ability to see through the port
- Reduced Artifact - better imaging capabilities
- Easily Identified



Radiopaque identifier for Power Symbol and flipped port detection.



Flipped Port

X-ray correct identification

Radiopaque identifier on the bottom of the port to aid in:

- Identification of the PowerPort™ device under X-ray
- Identification of a flipped port under x-ray

Are a New Breed of Ports for IV Therapy Treatments.

Enables Superior Imaging :

- Power injection and CECT scan capable when used with PowerLoc™ safety infusion set.
- Withstand 5 ml/s power injection @ 300 psi pressure limit setting
- Power-injected CECT scans produce superior images to help better manage patient care.

Easily Identifiable :

- Soft palpation points on septum
- Triangular port shape
- Patient Discharge Packet
- Radiopaque Identifier

Features & Benefits to

PowerPort™ *isp* Titanium device:

- Cosmetically appealing with compact size
- Lighter Weight for Patient Comfort
- Radiopaque
- Easily Identified
- Feel the "click" when accessing



PowerLoc™ Safety Infusion Set

The PowerLoc™ safety infusion set is the ideal device for accessing the PowerPort™ device. This power-combo enables contrast agents to be power-injected. As a result, tissues show up more clearly in CECT scans, making it easier to monitor patient condition. A variety of PowerLoc™ safety infusion set options are also available as accessory kits for continued PowerPort™ device access needs.

Features & Benefits :

Easy to Use :

- Ergonomic wing design provides controlled access and site visibility
- Safety mechanism that you can hear, see, or feel engage
- Dual port adaptability

Comfortable for the patient :

- Small foot print
- DEHP and latex-free
- Easy to dress
- Ultra Low Profile
- Lower insertion and penetration force than other port access needles

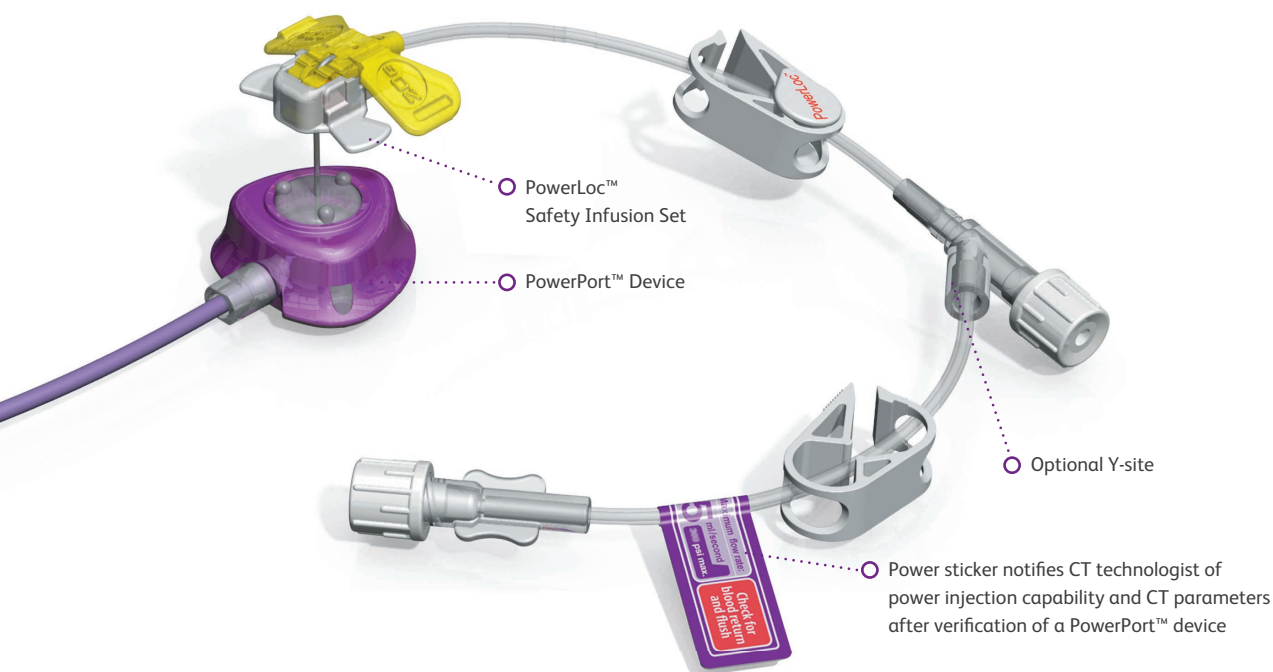

PowerLoc™ Safety Infusion Set with Y-Site

Product Code	Description with Y-Site	Max.Flow Rate@300psi
8671934	PowerLoc™ Safety Infusion Set, 19 Ga x .75" (19 mm)	5 ml/s
8671910	PowerLoc™ Safety Infusion Set, 19 Ga x 1" (25 mm)	5 ml/s
8672034	PowerLoc™ Safety Infusion Set, 20 Ga x .75" (19 mm)	5 ml/s
8672010	PowerLoc™ Safety Infusion Set, 20 Ga x 1" (25 mm)	5 ml/s
8672234	PowerLoc™ Safety Infusion Set, 22 Ga x .75" (19 mm)	2 ml/s

PowerLoc™ Safety Infusion Set without Y-Site

Product Code	Description without Y-Site	Max.Flow Rate@300psi
8651934	PowerLoc™ Safety Infusion Set, 19 Ga x .75" (19 mm)	5 ml/s
8652034	PowerLoc™ Safety Infusion Set, 20 Ga x .75" (19 mm)	5 ml/s

Minimum Gravity Flow Rate for PowerLoc™ Safety Infusion Set

19 Ga.	1,680 mL/hr
20 Ga.	960 mL/hr
22 Ga.	312 mL/hr

Maximum Priming Volume for PowerLoc™ Safety Infusion Set

19 Ga., 20 Ga. and 22 Ga.	with Y-Site - 0.4 mL
19 Ga., 20 Ga. and 22 Ga.	without Y-Site - 0.3 mL

PowerPort™ Implantable Port

Feel the NEW Standard of Care



	PowerPort™ Slim Implantable Port	PowerPort™ isp Implantable Port	PowerPort™ isp M.R.I Implantable Port
Reservoir Material	Titanium	Titanium	Plastic w/Titanium Markers and Stem
Base Diameter(mm)	28.0	30.0	29.0
Height(mm)	9.9	11.3	11.6



Powerport™ *isp* M.R.I. Implanted Port

Product Code	Code Description	Suture Plugs	Max. Flow Rate @ 300 Psi
8806060	Powerport™ <i>isp</i> M.R.I. device with 6 Fr. Attachable Chronoflex™ Catheter	Silicone Filled	5 ml/sec
8808060	Powerport™ <i>isp</i> M.R.I. device with 8 Fr. Attachable Chronoflex™ Catheter	Silicone Filled	5 ml/sec

Powerport™ *isp* Titanium Implanted Port

Product Code	Code Description	Suture Plugs	Max. Flow Rate @ 300 Psi
8706060	Powerport™ <i>isp</i> Titanium device with 6 Fr. Attachable Chronoflex™ Catheter	Silicone Filled	5 ml/sec
8708060	Powerport™ <i>isp</i> Titanium device with 8 Fr. Attachable Chronoflex™ Catheter	Silicone Filled	5 ml/sec

Powerport™ Slim Implanted Port

Product Code	Code Description	Suture Plugs	Kit Type
8716000	Powerport™ Slim Titanium Device with 6 Fr. Attachable Chronoflex™ Polyurethane Catheter	Silicone Filled	Intermediate

This port and needle combination enables safe power injections which result in clearer CT scans and easier monitoring of patient condition.

Please consult product labels and inserts for any indications, contraindications, hazards, warnings, cautions and instructions for use.

바드코리아(주) 06236 서울시 강남구 테헤란로 142, 15층
T. 02-2188-2900 F. 02-539-3081

bd.com/ko-kr

